

New Grafton bridge

Project update



The last of the 176 pre-cast segments for the bridge is slotted into place

The new Grafton bridge will transform the entry into the riverside city and change the way motorists, pedestrians and cyclists move around. This update outlines progress being made on the \$240 million NSW Government project and details upcoming work.



Work is beginning on
upgrading roundabouts



The new Grafton bridge
will transform road usage



Work continues on the New Grafton bridge

Bridge work

The last of the 176 pre-cast segments for the bridge was placed in August, resulting in a 525-metre span structure from the southern bank to the northern bank of the Clarence River.

Video of the final segment being lifted into place and time lapse footage of the project is available on the project website (www.rms.nsw.gov.au/graftonbridge).

Once opened, the bridge will alleviate the pressure on the existing bridge, making it safer for thousands of locals who use it each day as well as heavy vehicles, emergency services and holiday makers.

While the new bridge will be one lane each way when it opens, we are also planning for the future, with the new bridge having the ability to be expanded to two lanes each way.

The project team is targeting to have the bridge opened to traffic by the end of the year.

Roundabout at the intersection of Villiers and Dobie streets

Work to widen the roundabout at the intersection of Villiers and Dobie streets has also started and will be completed in coming weeks.

Trucks currently hit the kerb at this location, causing damage.

The work is required to widen the roundabout, providing more room for the turning paths of trucks.

Two existing power poles were relocated and a new power pole was installed in April as part of this work.

The work also includes removing vegetation, widening of the pavement, new kerb and finishing work and new line marking.

Roundabout at the intersection of Villiers and Pound streets

Work to upgrade the roundabout at the intersection of Villiers and Pound streets started in August and will be completed in the coming weeks.

Heavy vehicles will be required to use the new Grafton Bridge when it opens and the intersection of Villiers and Pound streets will become part of the new Summerland Way. We are replacing sections of the concrete roundabout, widening the road to allow trucks to turn and carrying out new kerb and finishing work.

When the work is complete the roundabout will be fully opened. We thank motorists and nearby residents and businesses for their patience while this work is being carried out.

Gwydir Highway roundabout work

Work has started to build a roundabout at the intersection of the Pacific and Gwydir highways. The roundabout will be built in stages over a number of months and is expected to open to traffic in the first half of 2020. Building the roundabout is a significant challenge due to the high volumes of traffic at this location, a narrow project boundary and unknown ground conditions.

Pacific Highway traffic was shifted in early August with the intersection moving slightly to the west to allow construction of the eastern part of the new roundabout. The eastbound section of the Gwydir Highway (Charles Street), from just west of the rail viaduct to the Pacific Highway, was reduced from two lanes to one. This arrangement will be in place until the new roundabout opens.

To avoid possible delays at this location, motorists wishing to travel north or south on the Pacific Highway should consider using the new intersection north of Bunnings.

A further two traffic switches are required to build the roundabout with the intersection continuing to operate as a t-intersection. To minimise impacts to nearby businesses and motorists on the Pacific and Gwydir highways, work, such as installing new

asphalt and line-marking, will be carried out at night for each traffic switch.

We will keep the community updated prior to any traffic changes and as the work progresses. The new roundabout is likely to be opened to traffic shortly after the Pacific Highway traffic is diverted onto the upgraded bypass of Grafton in 2020.



Work has started on the new Gwydir Highway roundabout

Temporary traffic changes during Stage 2 of work at the intersection of Villiers and Pound streets roundabout

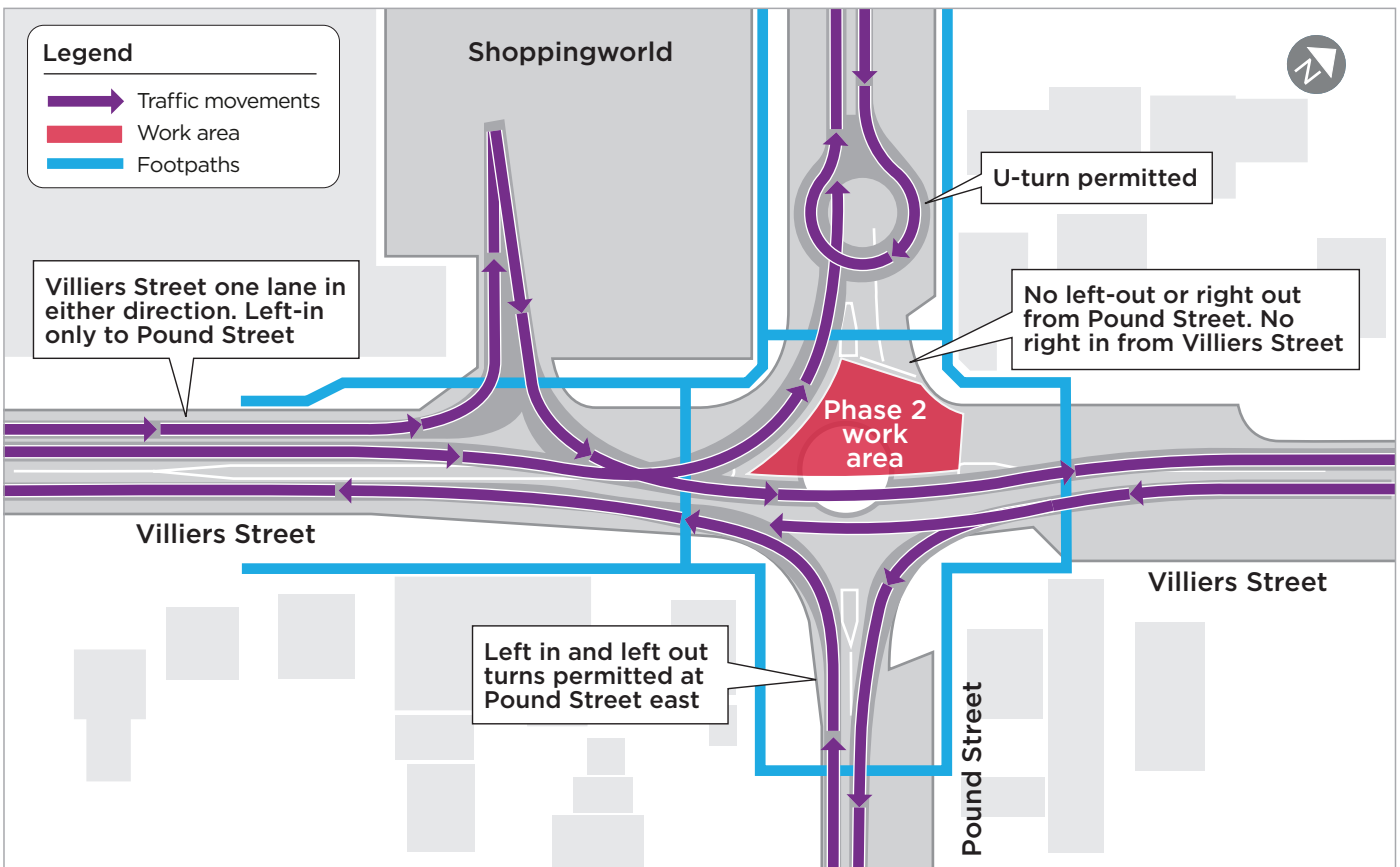

Butters Lane access

Butters Lane traffic has been diverted onto the final alignment. Entry to Butters Lane is off the new road behind Bunnings, while the exit from Butters Lane is about 50 metres to the south of where the current Butters Lane exits on to the main carriageway. We will be working with Butters Lane residents to ensure a smooth transition to the new traffic arrangement.

Upcoming activities

Key construction activities planned for the next three months include:

- completing barrier installation on the bridge
- installing the final asphalt surface and completing signage, lighting and line marking on the bridge and on the local approach roads
- completing the noise wall
- continuing landscaping
- completing replacement of sections of concrete pavement at the roundabout at the intersection of Villiers and Pound streets
- completing widening of the roundabout at the intersection of Villiers and Dobie streets
- completing the new Grafton pump station
- continuing the upgrade of Greaves Street
- continuing to build the Gwydir Highway roundabout.

Bridge opening

Planning is underway for an event to mark the bridge opening to traffic. We will keep key stakeholders and the community informed and provide more detail as we get closer to this important milestone.

Directional signage

The project team is developing a directional signage plan for the project. We are currently consulting key stakeholders about the plan. The community will be asked to provide feedback on the plan before the end of the year.

Permanent Butters Lane traffic arrangement

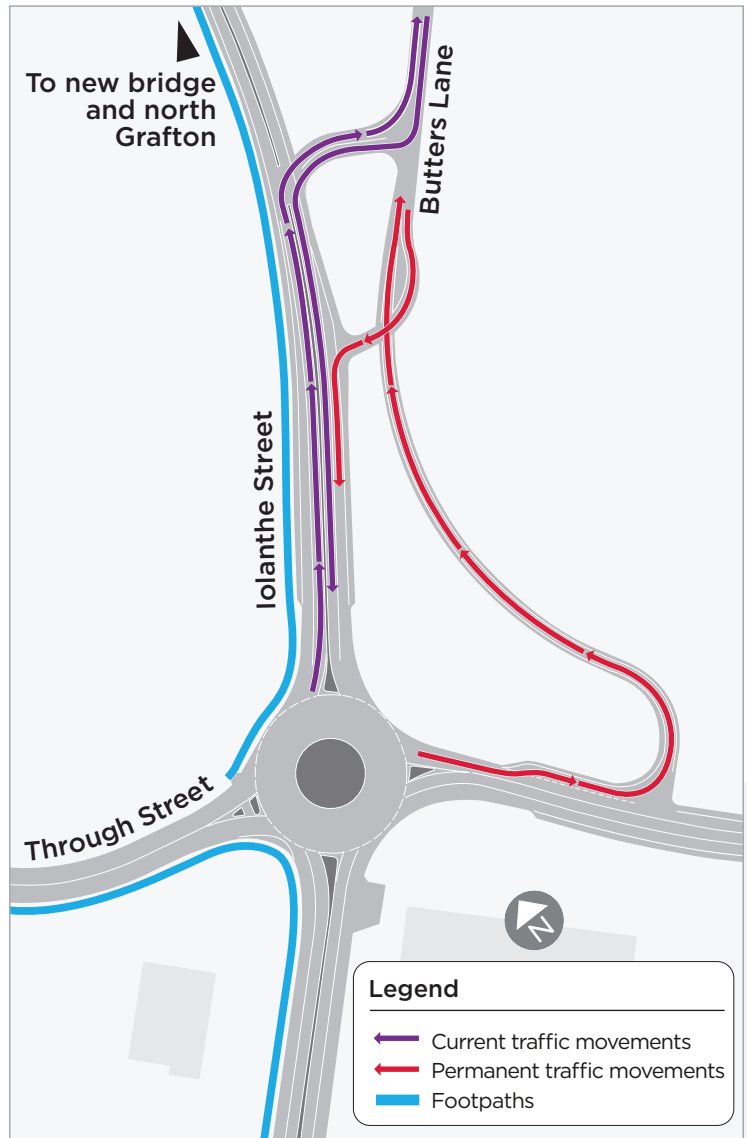

For more information, please contact us:

- ☎ 1800 918 759 (toll free)
- @ graftonbridgecommunity
- @ fultonhogan.com.au
- 🌐 www.rms.nsw.gov.au/graftonbridge
- ✉ PO Box 546 Grafton, NSW 2460

Contact
the
project
team

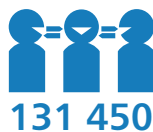

If you need help understanding the information, please contact the Translating and Interpreting Service on **131 450** and ask them to call us on **1800 918 759**

September 2019
RMS. 19.1368



Privacy: Roads and Maritime Services ("RMS") is subject to the *Privacy and Personal Information Protection Act 1998* ("PPIP Act") which requires that we comply with the Information Privacy Principles set out in the PPIP Act. All information in correspondence is collected for the sole purpose of assisting in the assessment of this proposal/ delivering this project. The information received, including names and addresses of respondents, may be published in subsequent documents unless a clear indication is given in the correspondence that all or part of that information is not to be published. Otherwise RMS will only disclose your personal information, without your consent, if authorised by the law. Your personal information will be held by RMS at 76 Victoria St, Grafton NSW. You have the right to access and correct the information if you believe that it is incorrect.