

Clarendon Station Upgrade

Community Notification | November 2022

Transport for NSW is upgrading Clarendon Station to make it easier for everyone to access public transport, including people with a disability or limited mobility, parents/carers with prams and customers with luggage.

Upcoming work

Work activities for November will include:

- relocating light poles to the back of the platforms
- installing wayfinding signage
- relocating the guard's indicator within the station boundary between 10pm 3 November and 8am 4 November (work will be inaudible with non-powered hand tools used only)
- installing structural steel on widened sections of platform.

Equipment to be used will include trucks, elevated work platforms, lifting aids, powered and hand tools.

More commuter car parking

An additional 14 commuter car park spaces will be created along Racecourse Road close to the station. The new spaces are being delivered as part of the NSW Government's Commuter Car Park Program, providing commuters with more convenient access to public transport at key interchanges and helping to ease congestion on our roads.

Construction hours

Standard construction hours are 7am to 6pm Monday to Friday and 8am to 1pm on Saturdays.

For the safety of staff, customers and the community, some work may be completed outside standard construction hours. We will notify nearby residents and businesses in advance if we need to work outside these times.

Thank you for your patience and understanding while we carry out this important work.

Keeping you up to date

We will continue to keep the community informed with regular project updates.

More information is available on the project website transport.nsw.gov.au/clarendon-station-upgrade. If you would like to be added to the project distribution list, please contact us on 1800 684 490 or email projects@transport.nsw.gov.au.

For all urgent enquiries or complaints regarding construction activities, please call our 24-hour Construction Response Line on 1800 775 465.

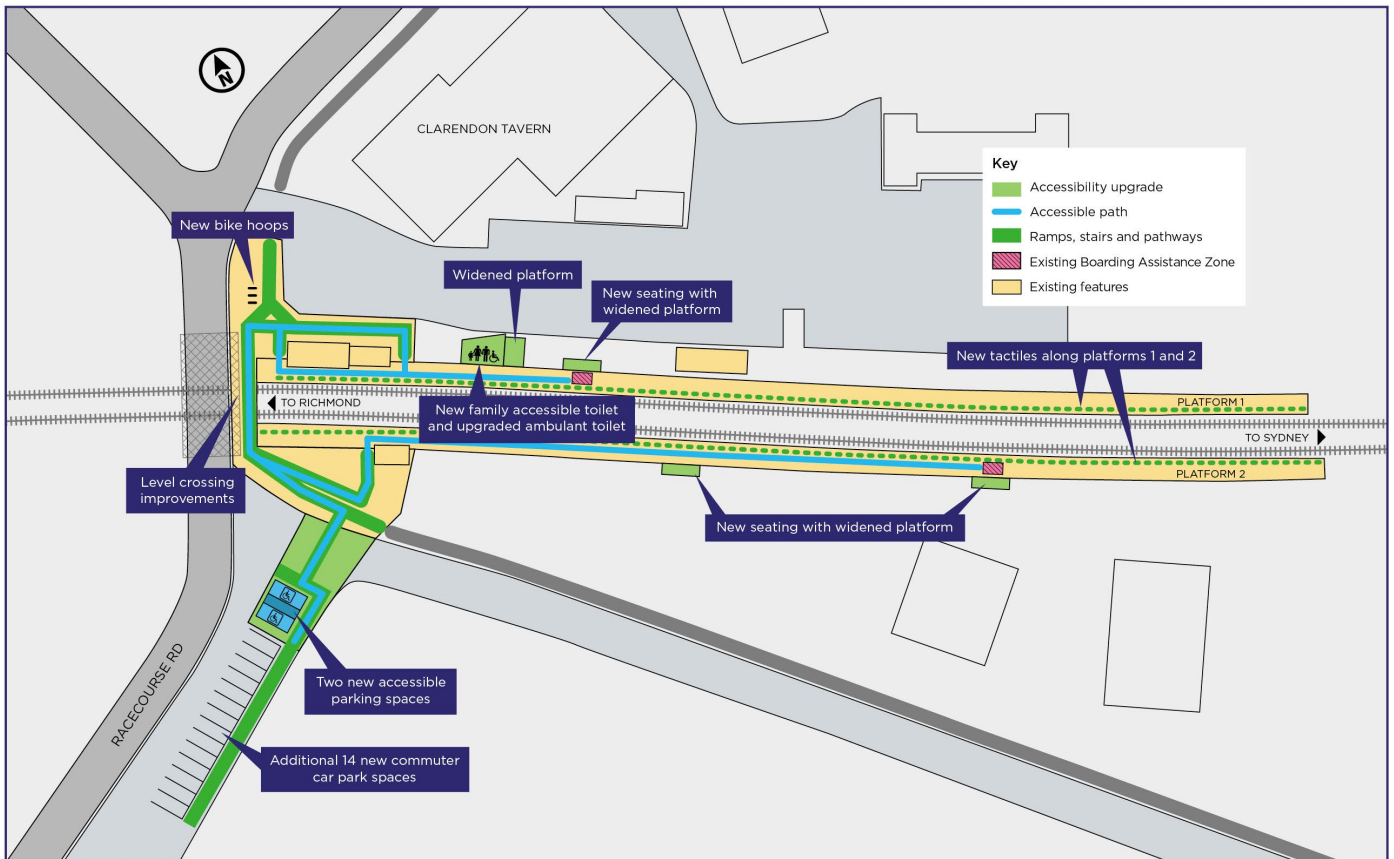

Key features of Clarendon Station Upgrade, subject to change during detailed design



Translating and interpreting service

If you need help understanding this information, please contact the Translating and Interpreting Service on **131 450** and ask them to call us on **1800 775 465**.

November 2022
Pub No 22.261

Privacy Transport for NSW (“TfNSW”) is subject to the Privacy and Personal Information Protection Act 1998 (“PIIP Act”) which requires that we comply with the Information Privacy Principles set out in the PIIP Act. All information in correspondence is collected for the sole purpose of assisting in the delivery of this project. The information received, including names and addresses of respondents, may be published in subsequent documents unless a clear indication is given in the correspondence that all or part of that information is not to be published. Otherwise we will only disclose your personal information, without your consent, if authorised by the law. Your personal information will be held by us at 27 Argyle Street, Parramatta. You have the right to access and correct the information if you believe that it is incorrect.