

Blackheath Station Upgrade

Transport Access Program

August 2023



Transport for NSW acknowledges the Darug and Gundungurra peoples as the Traditional Custodians of the lands on which we work and pays respect to Elders past and present.

Work to improve accessibility at Blackheath Station is now complete!

This upgrade was part of the Transport Access Program, an initiative of the NSW Government to provide a better experience for public transport customers by delivering modern, safe and accessible infrastructure.

What we delivered

- ✓ Three new lifts to station entries and platforms
- ✓ Upgrades to the existing accessible parking spaces, kiss and ride bay and taxi zone
- ✓ Removal of the non-compliant pedestrian level crossing
- ✓ Upgrades to station footpaths and platforms, including new tactiles and an accessible water fountain
- ✓ Improvements to CCTV, lighting and wayfinding
- ✓ Upgrades to the station footbridge, stairs and provision of new bicycle hoops.

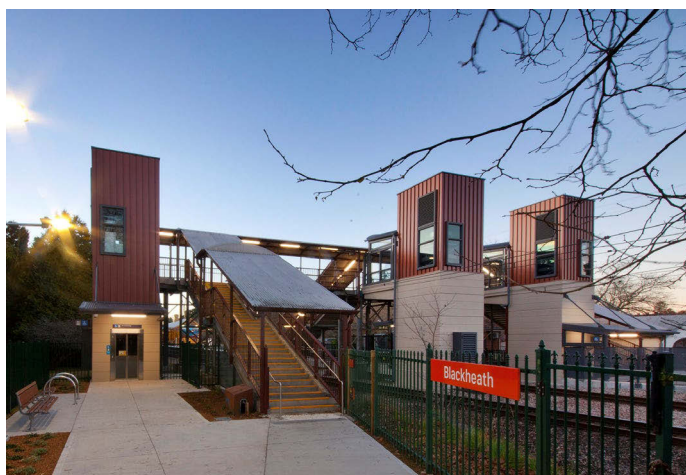

Above: New lifts to the station entries and platforms.

Planned finishing works

Finishing work will be carried out within and around the station from **6am to 6pm on Saturday 2 September and 6am to 10pm on Sunday 3 September**. Work activities including asphaltting on the station platform. Tactile installation on the platform will be completed during standard construction hours **7am to 6pm Monday to Friday** and **8am to 1pm on Saturdays**, due to be completed by the end of September, weather permitting.



Above: Local community celebrating the opening of the Blackheath Station

Thank you

Thank you to customers, local residents, businesses and our delivery contractors for your cooperation and patience.

We hope everyone, especially customers with a disability, limited mobility, carers/parents with prams and those travelling with luggage, will have an improved experience when catching the train at Blackheath Station.



Aboriginal artworks at Blackheath Station

As part of the project, we are honoured to have commissioned an artwork by proud Darug man, Shay Tobin, at the entrance to Blackheath Station.

The artwork 'Muru' features a topographical view of the Blackheath landscape and the ancient pathways across the ridges of the Blue Mountains. Indigenous communities surrounding the area travelled on these pathways to collect bee honey made from flannel flowers and other native flora that colour the landscape. The artwork shows the significance of these ancient routes to the people moving across the mountains today.

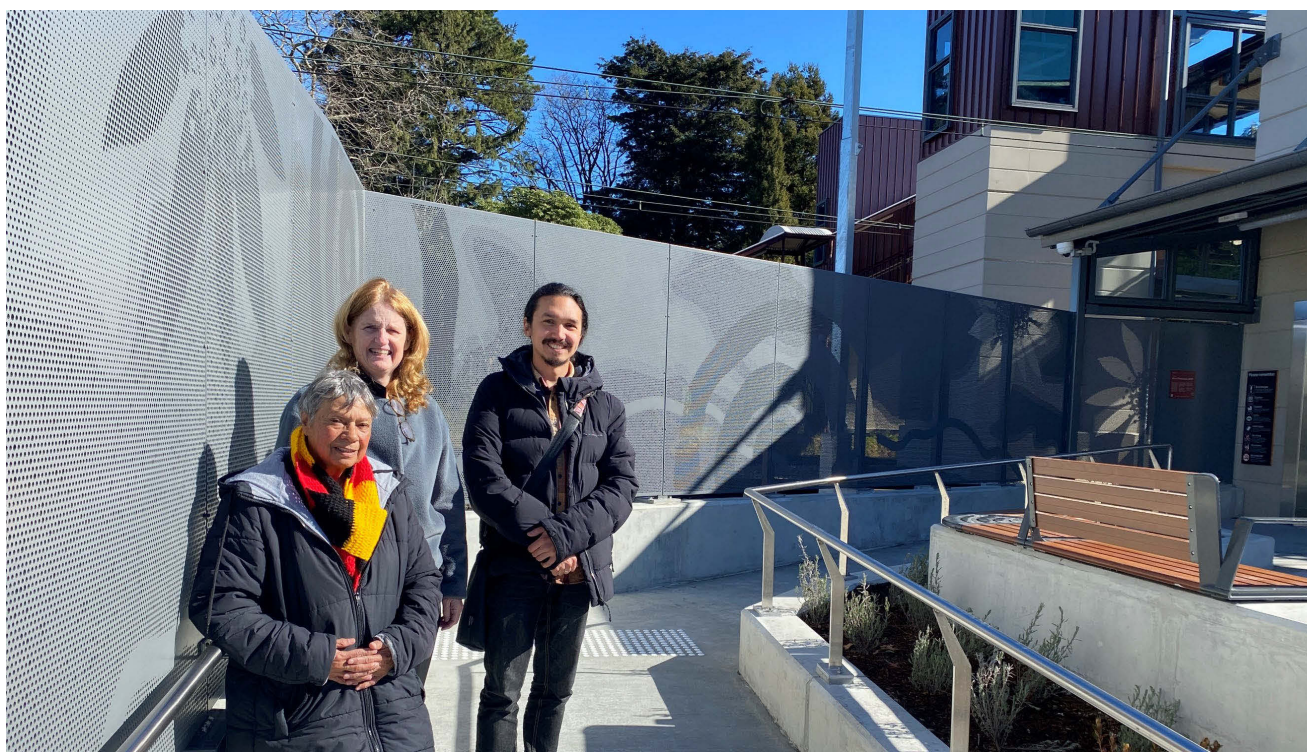

Above: Shay Tobin (Darug Artist), Aunty Carol Hooper & Jodie Towney

Contact us



Project Infoline **1800 684 490**
24-hour Construction Response Line **1800 775 465**



projects@transport.nsw.gov.au



www.transport.nsw.gov.au/blackheath



231 Elizabeth Street, Sydney
PO BOX K659, NSW 1240



If you need help understanding this information, please contact the Translating and Interpreting Service on **131 450** and ask them to call us on **1800 684 490**

www.transport.nsw.gov.au/privacy-statement#Your_Privacy